

Senatsverwaltung für Kultur und Europa	Senatsverwaltung für Stadtentwicklung und Wohnen	Der Regierende Bürgermeister von Berlin Senatskanzlei - Wissenschaft und Forschung	BERLIN	
---	--	--	---------------	---

ANNOUNCEMENT

Europe-wide open two-phase art competition

Kunst am Bau (Percent-for-Art) New Mathematics Buildings (MATH) and Interdisciplinary Centre for Modelling and Simulation (IMoS) of the Technische Universität Berlin, Fasanenstraße 89–90 in 10623 Charlottenburg-Wilmersdorf of Berlin

For the new Mathematics Building (MATH) and the Interdisciplinary Centre for Modelling and Simulation (IMoS) of the Technische Universität Berlin the State of Berlin is announcing a two-phase Europe-wide, open art competition for professionally active visual artists and artist groups. A total amount of up to 320,000.00 € is available for the realisation of the Kunst am Bau (Percent-for-Art) for MATH including all costs, fees and VAT. For the realization of the Percent-for-Art for IMoS there is a budget of up to 320,000.00 € available, including all costs, fees and VAT.

Awarding authority

Land Berlin, represented by the Senate Department for Culture and Europe, Public Art and Percent-for-Art on Buildings, in coordination with the Senate Department for Urban Development and Housing, Department V - Structural Engineering, and The Governing Mayor - Senate Chancellery, Science and Research.

Competition control

Dr. Ewa Gossart, Senate Department for Culture and Europe

Competition support

Gabriele Karau, kk-archpro

Nature of the competition procedure

The competition is an open, two-phase art competition for professionally active visual artists and artist groups throughout Europe.

The application and announcement of the procedure will be made via the online competition platform <https://www.wettbewerbe-aktuell.de/ovf?id=25759> in German and English. Registration for the competition is possible from the date of the announcement until 31.01.2022, 16:00 CET exclusively via the online platform. All those who have registered by then and meet the eligibility criteria will receive the link to the competition documents via the online competition platform from 09.02.2022.

The competition procedure will be conducted anonymously.

The competition language is German. The competition documents will be made available exclusively in German. All documents submitted by the participating artists must also be written and submitted in German. The participant colloquium with site visit colloquium of the second phase of the competition will also be held in German.

In the first phase, the participants are asked to develop basic artistic approaches in the form of an idea sketch with conceptual considerations for the new MATH building or the new IMoS building or for both new buildings. The jury will select up to 24 participants for the second phase, in which a detailed elaboration of the design for realisation is expected in addition to the basic approaches. The jury will judge in the same composition in both phases.

Principles and guidelines of the competition procedure

The competition will be held in accordance with the Guideline for Planning Competitions (RPW 2013), insofar as they are applicable to art competitions, and will follow the Guideline for Percent-for-Art and Public Art in the City of Berlin (Leitfaden Kunst am Bau und Kunst im Stadtraum für das Land Berlin, 2019).

Participating artists and groups of artists are asked to submit a work that is specifically conceived for this art competition and the competition task.

Competition entries that are published before or during the course of the procedure violate the anonymity required by § 1(4) and § 6(2) of the RPW 2013 and will not be accepted for evaluation by the jury.

All participants, all judges, all experts, preliminary examiners and guests agree to the conditions by their participation or involvement in the art competition.

Purpose and aim of the competition



Illustration: New mathematics building (MATH) at dusk, perspective from north-west © Code Unique Architekten, Dresden

As a structural science, mathematics is the universal basis for all natural sciences and engineering. In its pure, logical language, it describes and proves scientific relationships precisely. Applied mathematics finds solutions to problems in industry, technology and society.

Mathematics is a literature-intensive field of science. The places where mathematical ideas are created should be suitable for the specific way of working and meet high demands for quiet and concentration.

The existing mathematics building of the Technical University of Berlin on the Straße des 17. Juni, which was put into operation almost 40 years ago, was contaminated with asbestos and in great need of renovation. After thorough economic and renovation considerations, it was decided to construct a new replacement building for the Mathematics Department on the Fasanenstraße 89–90 site.

In an EU-wide competition for architectural firms to act as general planners for the disciplines of structural engineering, outdoor facilities, structural design and technical building services, Code Unique Architekten from Dresden, together with Rehwaldt Landschaftsarchitekten, Dresden, and CSZ Ingenieur Consult, Dresden/Berlin, were able to convince the jury with their project proposal and were awarded first prize. The jury particularly emphasised the visual appearance and open structure of the planned buildings: compact structures with inner courtyards that open up widely to the campus square on the ground floor and allow public passage. Rainwater can seep into the green areas between the buildings, in the inner courtyard and on the roof. The paths lead to the green space along the canal and to the zoo.

The new MATH and the new IMoS research building are closely related to each other in terms of content, construction and planning. The planning and construction of the two building measures are being carried out together, coordinated in terms of time and space.

The program of Kunst am Bau (Percent-for-Art) of the State of Berlin is an integral part of public building culture. In connection with the construction project, the State of Berlin, represented by the Senate Department for Culture and Europe in coordination with the Senate Department for Urban Development and Housing and with The Governing Mayor of Berlin, Senate Chancellery for Science and Research, is launching a joint Europe-wide open two-phase art competition for the two new buildings.

The aim of the art competition is to create a Kunst am Bau (Percent-for-Art) for the new MATH building and for the new IMoS building that makes reference to the location, its architectural and spatial context, and engages with the vibrant places of teaching and research, as well as exchange. The choice of artistic medium is up to the participants.

The new MATH building will be used by almost all students of the Technical University Berlin in the first semesters during their basic mathematics training. In addition, it will be home to professors, staff and doctoral students of the Institute of Mathematics. The new IMoS building will be a place for application-driven research and international encounters across disciplines.

The main issue of the project partners is to emphasize the themes of internationality and interdisciplinarity: at this location, both top international research and application-oriented teaching will take place. For the research and teaching envisaged in the two new buildings, a place is needed that not only allows but also promotes communication and cooperation.

The aim of the art competition is to create an independent artistic contribution that establishes an identity-forming relationship to the location and its spatial, architectural and social situation and convinces through artistic quality and expressiveness.

Purpose of the competition

The purpose of the art competition is to develop a Kunst am Bau (Percent-for-Art) for the new MATH building and for the new IMoS building that makes reference to the location, its architectural and spatial context, engages with the new buildings as lively places of teaching and research, as well as exchange, and reflects the themes of internationality and interdisciplinarity.

Participants are free to choose their artistic medium as long as the use of the respective competition area is not restricted and the architects' copyrights are respected.

The artists are free to submit an artistic concept for the new building A_MATH or the new building B_IMoS or for both new buildings AB_MATH/IMoS.

Art Competition Area

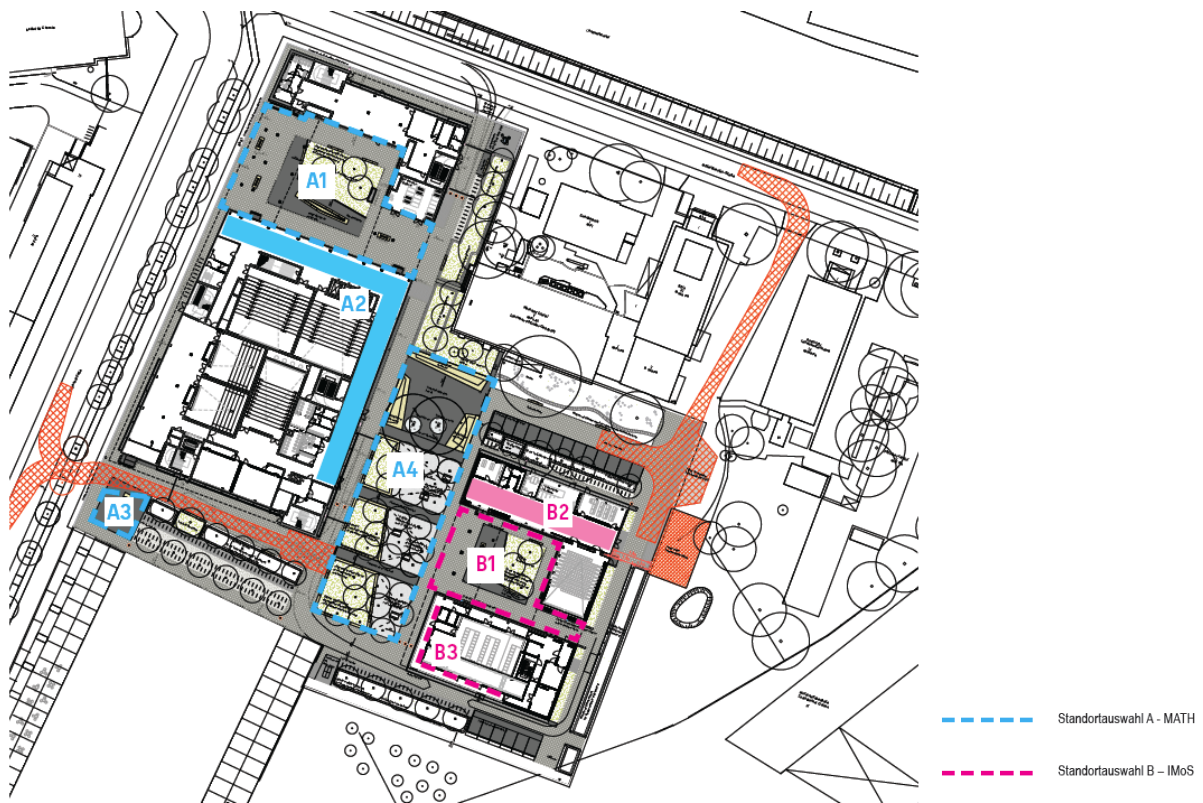

Site plan showing the competition locations © Code Unique Architekten, Dresden, and Rehwaldt Landschaftsarchitekten Dresden/Berlin

A - New building Mathematics (MATH)

- A1 MATH courtyard and corridor
- A2 MATH Foyer from ground floor to 6th floor and corridor ground floor
- A3 MATH Open space at the south-west corner of the site
- A4 MATH Green centre

Sites A1, A3 and A 4 are outside, A 2 inside the building.

An art concept/draft for the new MATH building may include one or more of the possible locations A1 to A4.

B - New building Interdisciplinary Centre for Modelling and Simulation (IMoS)

- B1 IMoS courtyard and passageway
- B2 IMoS foyer
- B3 IMoS wall area corridor - wall area in the ground floor south corridor area that can be seen from the outside (area is only accessible to authorized persons, not to the general public).

Location B1 is outside, locations B2 and B3 are inside the building.

An art concept/draft for the new B IMoS building may include one or more of the possible locations B1 to B3.

The submission of an art concept/draft that includes one or more locations of A (MATH) and one or more locations of B (IMoS) is also possible.

The competition participants may submit only one art concept/draft without variants for either A or B or AB.

Required application documents

In the first phase of the art competition, participants are asked to develop basic artistic solutions in the form of an idea sketch with conceptual considerations for the new MATH building or the new IMoS building or for both new buildings. The jury will select up to 24 participants for the second phase of the art competition. In the second phase, the detailed elaboration and concretization of the art concept for realisation is expected. The jury will judge in the same composition in both phases.

The required application documents will be communicated with the competition text.

Jury

expert judges

- Prof. Peggy Buth, artist/professor of photography
- Karin Kasböck, artist
- David Krippendorff, artist
- Andrea Pichl, artist
- Katrin Schmidbauer, artist

judges

- Prof. Dr. Etienne Emmrich, mathematician, Dean of Faculty II - Mathematics and Natural Sciences at the TU Berlin
- Volker Giezek, architect, Code Unique Architekten
- Sven Holzgreve, Department V - Structural Engineering of the Senate
Department for Urban Development and Housing
- René Vonau, Head of Department Building / IV L of the TU Berlin

Summary of the dates

(subject to Covid-19 pandemic containment measures)

23.12.2021 until 31.01.2022, 16:00 CET - online application period

until 08.02.2022 - examination of the applications with regard to the criterion
“professional artistic activity”

09.02.2022 - distribution of the competition announcement via online platform

by 02.03.2022 - written queries 1st phase via the online platform

by 11.03.2022 - written response to the queries of the 1st phase via the online platform

by 13.04.2022 - digital submission of the documents for the 1st phase via the online platform

01./02.06.2022 - meetings of the jury 1st phase

03.06.2022 - Notification of participants in the 2nd phase

30.06.2022 - participant colloquium 2nd phase

by 15.07.2022 - written queries of the 2nd phase via the online platform

by 29.07.2022 - written response to the queries of the 2nd phase via the online platform

09/10.11.2022 - meetings of the jury 2nd phase

probably 25.11.2022-09.12.2022 - exhibition of the submitted drafts

Realization sum

For the realization of the art, a total of up to € 320,000.00 incl. VAT is available for the new building A Mathematics (MATH) and a total of up to € 207,000.00 incl. VAT for the new building B Interdisciplinary Centre for Modelling and Simulation (IMoS), including in each case all costs for fees, management, material and production, as well as all ancillary costs. A total of up to 527,000.00 € incl. VAT is available for a comprehensive art concept for AB, which includes the sites A MATH and B IMoS. The costs for a comprehensive concept AB are to be submitted separately for A and B in phase 2.

It is imperative that the respective overall cost framework is adhered to, as no further funds are available beyond this.

Expense allowance for competition participation and prize money

Participants in the first phase of the competition will not receive any expense allowance.

Each participant in the second phase of the competition (maximum of 24 individual applications or working groups) will receive an expense allowance of 2,400.00 euros including VAT, provided that an art concept/draft in accordance with the conditions of the competition is submitted on time.

No prize money will be awarded.

Registration

Registration for the competition procedure takes place exclusively online via <https://www.wettbewerbe-aktuell.de/ovf?id=25759> . The application must be submitted by 31.01.2022, 16:00 CET. Technical queries regarding the online application will be answered from 10.01.2022 until 31.01.2022, 15:00 CET by wettbewerbe aktuell, Ms Stöcks, e-mail: stoecks@wettbewerbe-aktuell.de.

Eligibility - europe-wide open registration procedure

Natural persons working as professionally active visual artists and artist groups (working groups) who have registered to participate at <https://www.wettbewerbe-aktuell.de/ovf?id=25759> by Monday, 31.01.2022, 16:00 CET are eligible to participate in the competition.

The eligibility requirements must be met on the day of the competition announcement. The prerequisites for successful registration are: a relevant degree from an art academy or similar and/or a professional artistic activity proven by a curriculum vitae and list of exhibitions and/or membership in an artists' association.

Eligible applicants will receive the competition announcement on 09.02.2022; from 09.02.2022 the competition announcement documents will be available for downloading by authorized participants via the online platform.

Working groups are considered as one competition participant. Each member of a working group must be entitled to participate. Working groups must appoint an authorized representative. Legal entities are not eligible to participate.

Participation of individual members of working groups in more than one working group is not permitted and will result in the exclusion of all works affected.

Eligibility for participation will be checked by the competition management after the closing date for entries while maintaining anonymity. In the event of a successful check, only the persons named in the application may participate in the art competition. The awarding authority reserves the right to carry out a further check of eligibility after the completion of phase 1.

Excluded from participation in the art competition are persons who were directly involved in the preparation of the competition task and the announcement as well as all persons involved in the jury procedure and the preliminary examination.

Data protection

Each participant, each judge, expert, preliminary examiner and guest agrees, through his/her participation or involvement in the competition, that his/her personal data in connection with the above-mentioned competition may be kept by the awarding authority in the form of an automated file.

In accordance with § 6 of the amended Federal Data Protection Act, the consent of the participants is required, as there is no specific legal basis for keeping this file. The data is stored for a limited period of time in accordance with the respective legal provisions. The deletion of personal data is governed by Art. 17 DSGVO and usually takes place when they are no longer necessary for the purposes for which they were collected or otherwise

Art competition Kunst am Bau (Percent-for-Art) MATH and IMoS

processed (conclusion of the competition procedure), the underlying consent is revoked or objection to the processing is raised.

Recipients of the data

The recipients of the data are the competition management, competition support and online competition platform.